

McElroy/Catchot Winches
 Models: Stroudsburg 515, 515T, 515.5T, 518T, 519T, 520T

McElroy/Catchot Winches
 Models: Stroudsburg 515, 515T, 515.5T, 518T, 519T, 520T

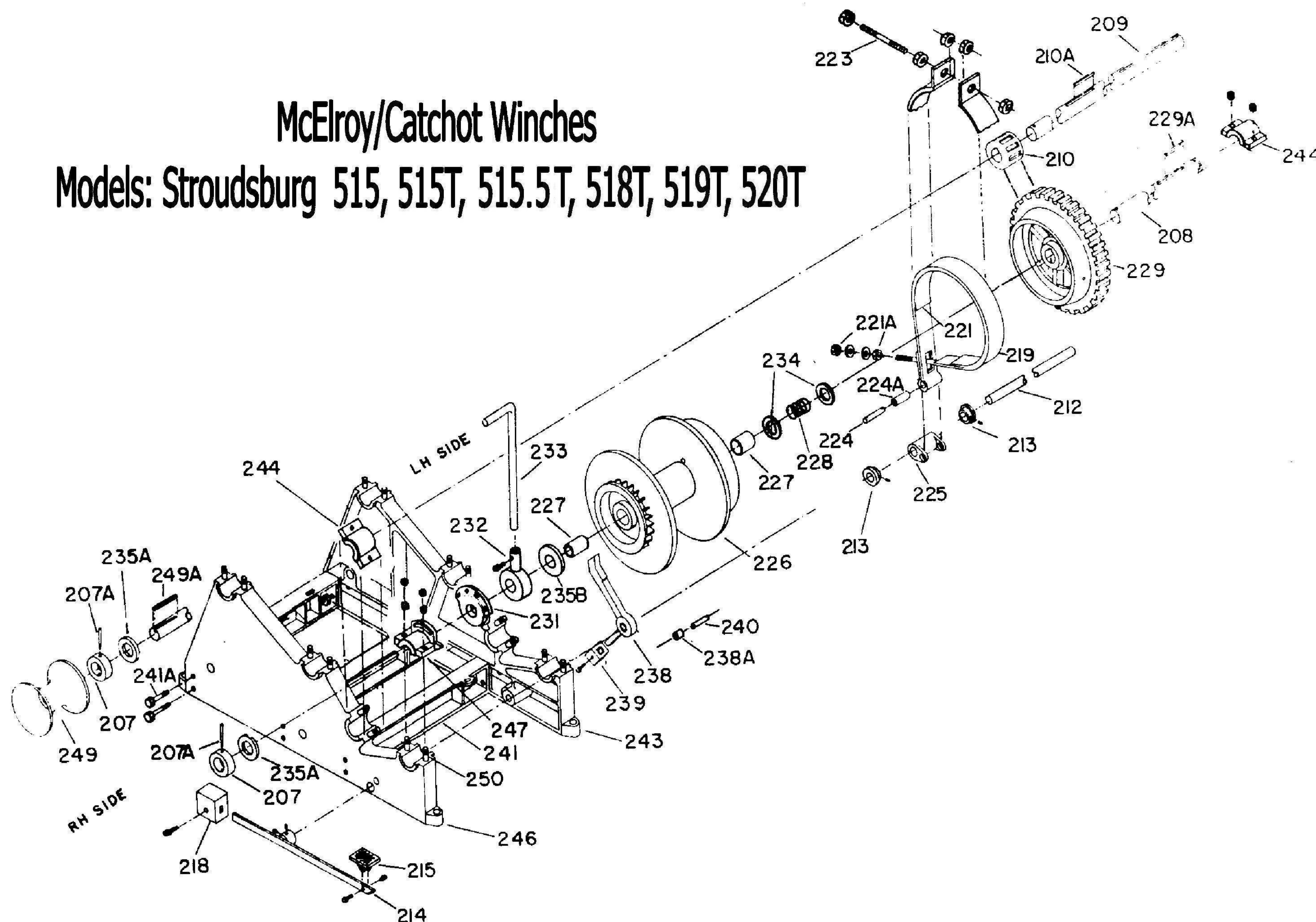

207	Drum shaft collar taper pin
207A	Drum shaft collar taper pin
*208	Drum shaft collar taper pin
209	Pinion shaft
210	Main drive pinion
210A	Main drive pinion key
*212	Brake shaft
213	Brake shaft collar
214	Brake lever assembly less weight, #218
215	Brake lever foot pad
218	Brake lever weight
*219	Brake band complete with lining
*221	Brake lining
221A	Nuts and washers for brake end bolt
223	Brake band bolt and nuts
224	Brake band toggle pin
224A	Brake band toggle pin bushing
225	Brake band toggle
*226	Friction drum
227	Friction drum bushing
228	Friction drum spring
229	Friction gear
229A	Friction gear key

230	Friction gear ring (not shown) Model#498, 515 and 515T hoist only.
*231	Stationary friction cam
*232	Movable friction cam
233	Movable friction cam lever
234	Steel drum spring washer
235A	Outside bronze thrust washer
235B	Inside bronze thrust washer
*238	Drum pawl with bushing
238A	Drum pawl bushing
*239	Drum pawl weight
240	Drum pawl pin
*241	Cross beam
241A	Cross beam mounting bolts and nuts
243	Left hand side frame
244	Left hand drum shaft cap; Right hand or Left hand pinion shaft cap
246	Right hand side frame
*247	Drum shaft cap for right hand side frame
249	Winch head
249A	Winch head key
250	Bearing cap studs with nuts
251	Gear guard assembly (not shown); Specify model hoist for which guard is required

* Specify for which drum part is required; Lower, Middle or Upper.